



## Setting The Tile Cutter

Place the tile cutter on a flat surface.  
Fit the angle guide if supplied



Attach the angle guard to the top of the cutter



Tighten knob to secure angle guide

## Straight Cuts

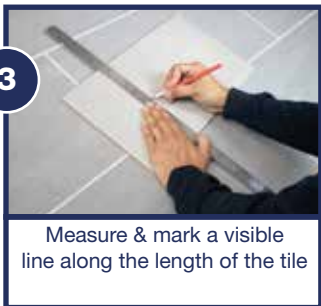

Measure & mark a visible line along the length of the tile

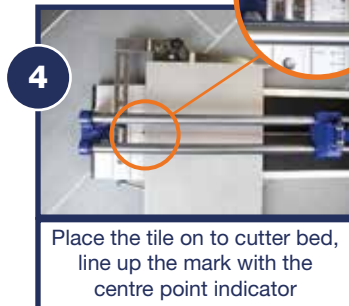

Place the tile on to cutter bed, line up the mark with the centre point indicator

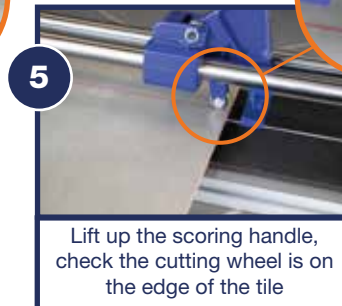

Lift up the scoring handle, check the cutting wheel is on the edge of the tile

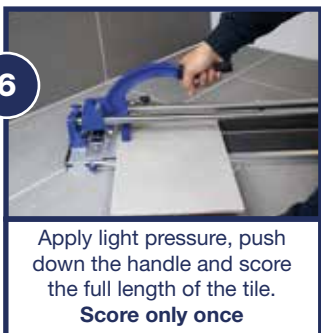

Apply light pressure, push down the handle and score the full length of the tile.  
**Score only once**

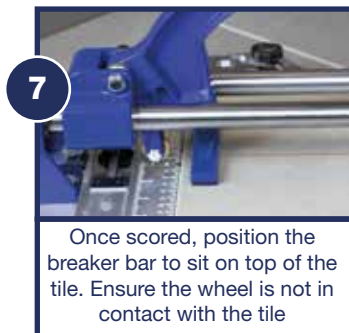

Once scored, position the breaker bar to sit on top of the tile. Ensure the wheel is not in contact with the tile

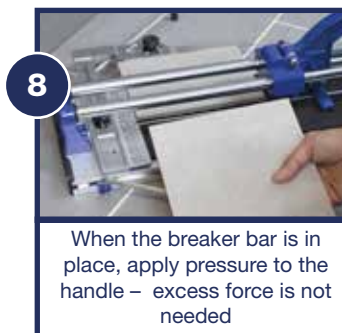

When the breaker bar is in place, apply pressure to the handle – excess force is not needed

## Angled Cuts



Measure & mark a visible line along the length of the tile



Position the guide to the required angle



Repeat steps 5-8

## Tips

- Use a Tile File to smooth sharp edges
- For smaller cuts and shaping, use Tile Nippers
- After cutting is complete, clean the cutter to prolong its life

