

BP-0423

USER MANUAL

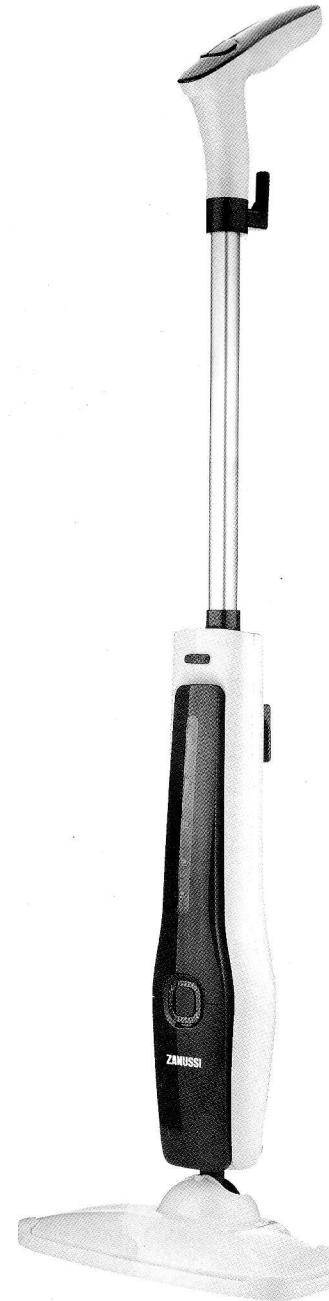

ZSM-Z6001UK

ZANUSSI

CONTENTS

- Important Safeguards
- Parts Description
- Operating Instructions
- Features
- Care and Maintenance
- Troubleshooting
- Correct Disposal

Important Safeguards



Read all instructions thoroughly before first use, even if you are familiar with this type of product. The safety precautions mentioned in this manual reduce the risk of burns, fire, electric shock and injury when correctly followed. Keep this manual in a safe place for future reference, along with the completed warranty card, purchase receipt and packaging. If applicable, pass these instructions onto the next owner of this appliance.

⚠ WARNING - This signal term indicates a moderate risk, which, if not avoided, may result in death or severe injury.

⚠ CAUTION - This signal term indicates a low risk, which, if not avoided, may result in minor or moderate injury.

NOTE - This signal term warns you of potential damage.

When using your steam mop, basic safety precautions should always be observed, including the following:

⚠ WARNING - To reduce the risk of fire, electrical shock, or injury:

- Read all instructions before using your steam mop.
- Do not use outdoors.
- Do not leave the appliance unattended when plugged in. Always unplug the power cord from the electrical outlet when not in use and before servicing.
- Do not allow the appliance to be used as a toy. Close attention is necessary when used by or near children, pets or plants. Do not leave appliance unattended while connected.
- Use only as described in this manual.
- Use only manufacturer's recommended accessories.
- Do not operate the appliance with a damaged plug or cord, or if the unit has been dropped or damaged. To avoid the risk of electric shock, do not disassemble or attempt to repair the appliance on your own. Incorrect re-assembly or repair can cause a risk of electrical shock or injury to persons when the appliance is used.
- To protect against a risk of electric shock, do not immerse the steam mop into water or any other liquids.
- Do not pull or carry by power cord, use power cord as handle, close a door on the power cord, or pull the power cord around sharp edges or corners. Keep power cord away from heated surfaces.
- Do not unplug by pulling on power cord. Do not use extension cords or outlets with inadequate current carrying capacity.
- Do not handle plug or steam mop with wet hands or operate the appliance without shoes.
- Do not put any objects into openings. Do not use with any opening blocked.

- Do not put hands or feet under the steam mop. Unit get very hot.
- Use only on flat, horizontal surfaces. Do not use on walls, counters or windows.
- Do not use on leather, wax polished furniture or floors, synthetic fabrics, velvet or other delicate, steam sensitive materials.
- Do not add cleaning solutions, scented perfumes, oils or any other chemicals to the water used in this appliance as this may damage the unit or make it unsafe for use. If you live in a hard water area, we recommend using distilled water in your steam mop.
- Never direct steam towards people, animals or plants.
- Carefully remove the micro-fiber pad immediately after you have finished using the steam mop.
- When cleaning the steam mop, unplug the power cord from the electrical outlet and clean with a dry or damp cloth. Do not pour water or use alcohol, benzene or paint thinner on the unit.
- Extreme caution should be exercised when using this appliance to clean stairs.
- Never use steam mop without micro-fiber pad attached.
- Store steam mop indoors in a cool, dry place.
- To avoid circuit overload, do not operate another appliance on the same socket (circuit) as the steam cleaner.
- Do not leave unattended when the system is connected to a power supply/electrical outlet.

⚠ WARNING - Do NOT modify the plug in any way.

⚠ WARNING - Your steam mop is designed to clean hard floor surfaces that will withstand high heat. Do not use on unsealed wood or unglazed ceramic floors. On surfaces that have been treated with wax or some no wax floors, the sheen may be removed by the heat and steam action. It is always recommended to test an isolated area of the surface to be cleaned before proceeding. We also recommend that you check the use and care instructions from the floor manufacturer.

IMPORTANT: Do not store unit with damp/wet micro-fiber cleaning pad attached. Never leave the steam mop in one spot on any surface for any period with a damp or wet micro-fiber cleaning pad attached as this will damage your floors.

IMPORTANT: Do NOT store cleaning solutions, scented perfumes, oils or any other chemicals to the water used in this appliance. If you live in a hard water area, we recommend using distilled water in your steam mop.

⚠ WARNING: Danger of Scalding. Please use caution when using the steam mop. The steam emitted from the openings is extremely hot.

Parts Description

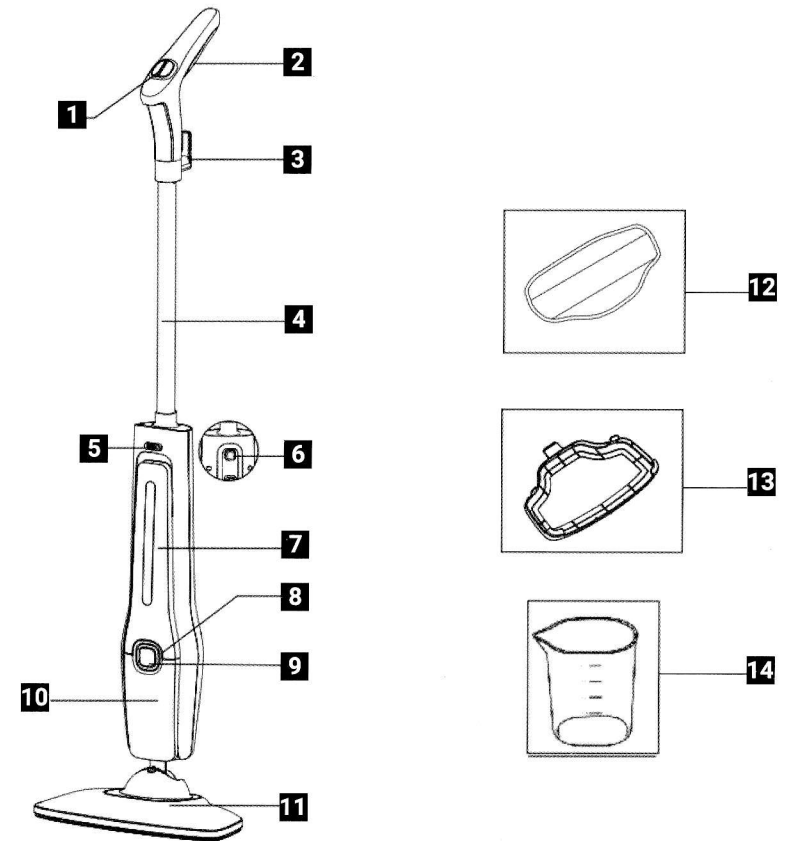

① Select switch

② Cover for battery box

③ Cord wrap

④ Support rod

⑤ Release button for water tank

⑥ Release button for support rod

⑦ Water tank

⑧ Power light

⑨ Power switch

⑩ Main body

⑪ Mop head

⑫ 2pcs mop pads

⑬ 1pc carpet glider

⑭ 1pc jug

Operating Instructions

How to Assemble Your Steam Mop

1. Remove all the parts from the packaging.
2. Take out the handle, slide the lock button to "🔓" position and open the cover. Put 2*AAA battery in it. Slide the lock button to "🔒" position to close the cover.(as shown in figure 1)

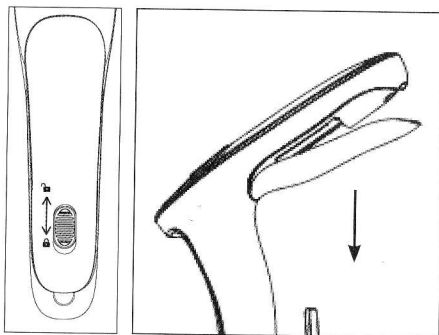

Fig.1

3. After assembled, insert handle into the tube. (as shown in figure 2)

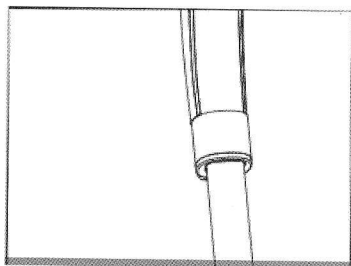

Fig.2

4. To disassemble the handle, pull out the cord wrap. (as shown in figure 3)

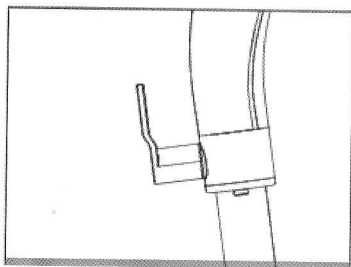

Fig.3

5. Push release tab on tube, then insert tube assembled with handle into main body. Make sure that the locking tab snaps into place.
6. To disassemble the tube, push release button on back of main body, then pull it out. (as shown in figure 4)

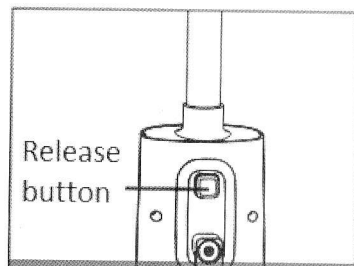

Fig.4

Using Steam Mop

Important: Never use the steam mop without the micro-fiber cleaning pad attached to the mop head or without water in the water tank.

1. Sweep the floors before using the steam mop.
2. Place the micro-fiber cleaning pad underneath the mop head. Make sure that the white coloured side is facing up. (as shown in figure 5)

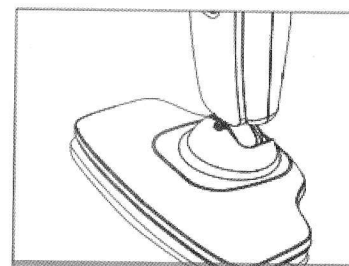

Fig.5

Important: Always ensure that the unit is "unplugged" from the wall receptacle prior to filling and before attaching the micro-fiber cleaning pad to the bottom of the mop head. Never use the steam mop without the micro-fiber cleaning pad attached to the mop head.

3. Push the "PUSH" button on main body, lift to remove the water tank. (as shown in figure 6)

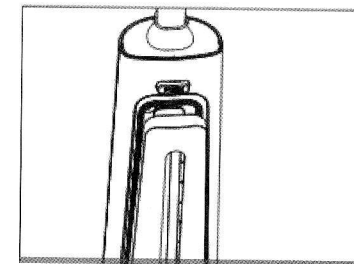

Fig.6

4. Turn the cap counterclockwise (as shown in figure 7), using the filling funnel, pour the water into water tank. Do not overfill the water tank. Keep the water level below the TOP line marked "450" ml.

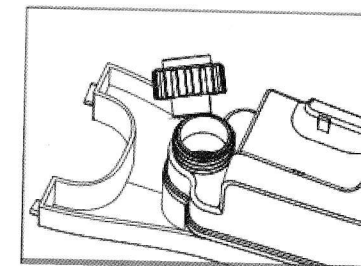

Fig.7

5. Replace cap onto the water tank.
6. Replace water tank onto main body.
7. Twist the quick release cord holder to unwrap the power cord completely.
8. Plug into electrical outlet, with the same voltage as shown on the rating plate.
9. Turn on power switch.
10. Select power on handle. (as shown in figure 8)

Features

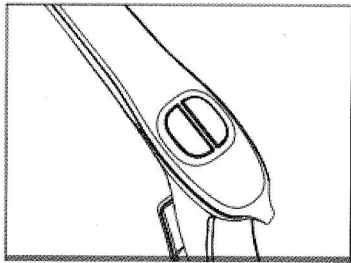

Fig.8

11. It takes approximately 30 seconds for the unit to heat up and the steam to be ready.
12. Wait seconds, dampen the micro-fiber cleaning pad first, begin mopping with a forward and backward motion, it will release steam as you mop.
13. When water tank is empty, the steam mop will stop emitting steam. Unplug the power cord from the electrical outlet and refill the water tank following the instructions above.
14. Remove cleaning pad, put carpet glider to clean the carpet at home.

Steam mop utilizes steam to remove tough grease; dirt and grime. Cleaning the house without using harsh chemicals, therefore it is perfectly ecological. It can be used to clean your tile, hardwood, ceramic tiles, linoleum and vinyl floors.

Quick & Easy

Eliminates rinsing, wringing, carrying buckets of water and redistributing the dirt on the floor. Save your time to clean up the floors.

Sanitizing

Powerful steam helps for superior cleaning and sanitizing.

No Chemical Used

Use tap water or distilled water, perfectly ecological.

Quick Start-Up

Steam is ready in just 30 seconds.

Reusable and washable cleaning pad

Static Protection

When the product is standing upright, it will stop working to protect floor, the indicator light keeps green but flashes.

When the water tank is detached from the product, the pump will stop working automatically, the indicator light keeps green but flashes.

Care and Maintenance

Lack-Water Protection

The pump will stop working automatically after continuous working around 60s when there is no water, meanwhile, the indicator light turns red and flashes. Pump will resume working after refilling water.

Energy Saving for Battery

Without touching the select switch, the appliance will stop working to prolong the use time for batteries.

If you consistently use distilled water, cleaning the water tank is not necessary.

⚠ CAUTION - This appliance must be unplugged from the electrical outlet before performing any cleaning or maintenance tasks on the unit.

Care for the micro-fiber cleaning pad

1. Wash the pad with a mild detergent.
2. Put it in a washing machine using the warm water setting, and separate from other clothes or place it in a garment bag first.

Rinsing Out the Steam Mop

1. Let the appliance cool down completely before cleaning or storing.
2. Empty all water from the water tank after each use.

Water

1. Use tap water for all your cleaning needs.
2. However, if you live in an area with hard water, it is recommended that you use distilled water.

Troubleshooting

PROBLEM	POSSIBLE CAUSE	SOLUTION
Steam mop will not operate.	<ol style="list-style-type: none"> 1. Power cord not firmly plugged into outlet. 2. No power in wall outlet. 3. Needs servicing. 	<ol style="list-style-type: none"> 1. Plug unit in firmly. 2. Check fuse or breaker. 3. Replace fuse/reset breaker.
Steam mop will not make steam.	<ol style="list-style-type: none"> 1. No water in tank. 	<ol style="list-style-type: none"> 1. Add water to the water tank following instructions.
Steam mop leaves water on the floor.	<ol style="list-style-type: none"> 1. Micro-fiber cleaning pad is too wet. 	<ol style="list-style-type: none"> 1. Unplug unit from power outlet and change the micro-fiber cleaning pad.
Steam mop left white spot in floor.	<ol style="list-style-type: none"> 1. Steam mop left in one spot too long. 2. Hard water. 	<ol style="list-style-type: none"> 1. Never leave the steam mop on the floor with a damp or wet cleaning pad still attached when not in use. 2. Use distilled water.

Correct Disposal

Environment Friendly Disposal

Correct disposal of this product



This marking indicates that this product should not be disposed with other household wastes throughout the EU. To prevent possible harm to the environment or human health from uncontrolled waste disposal, recycle it responsibly to promote the sustainable reuse of material resources. To return your used device, please use the return and collection systems or contact the retailer where the product was purchased. They can take this product for environmental safe recycling.

Technical Specifications

SPECIFICATIONS	
RATED VOLTAGE	220-240V~
RATED FREQUENCY	50/60Hz
RATED POWER	1300W