



register and win!
www.karcher.com

 **KÄRCHER**[®]

T 200
T-Racer



Deutsch	3
English	5
Français	7
Italiano	9
Nederlands	11
Español	13
Português	15
Dansk	17
Norsk	19
Svenska	21
Suomi	23
Ελληνικά	25
Türkçe	27
Русский	29
Magyar	31
Čeština	33
Slovenščina	35
Polski	37
Românește	39
Slovenčina	41
Hrvatski	43
Srpski	45
Български	47
Eesti	49
Latviešu	51
Lietuviškai	53
Українська	55



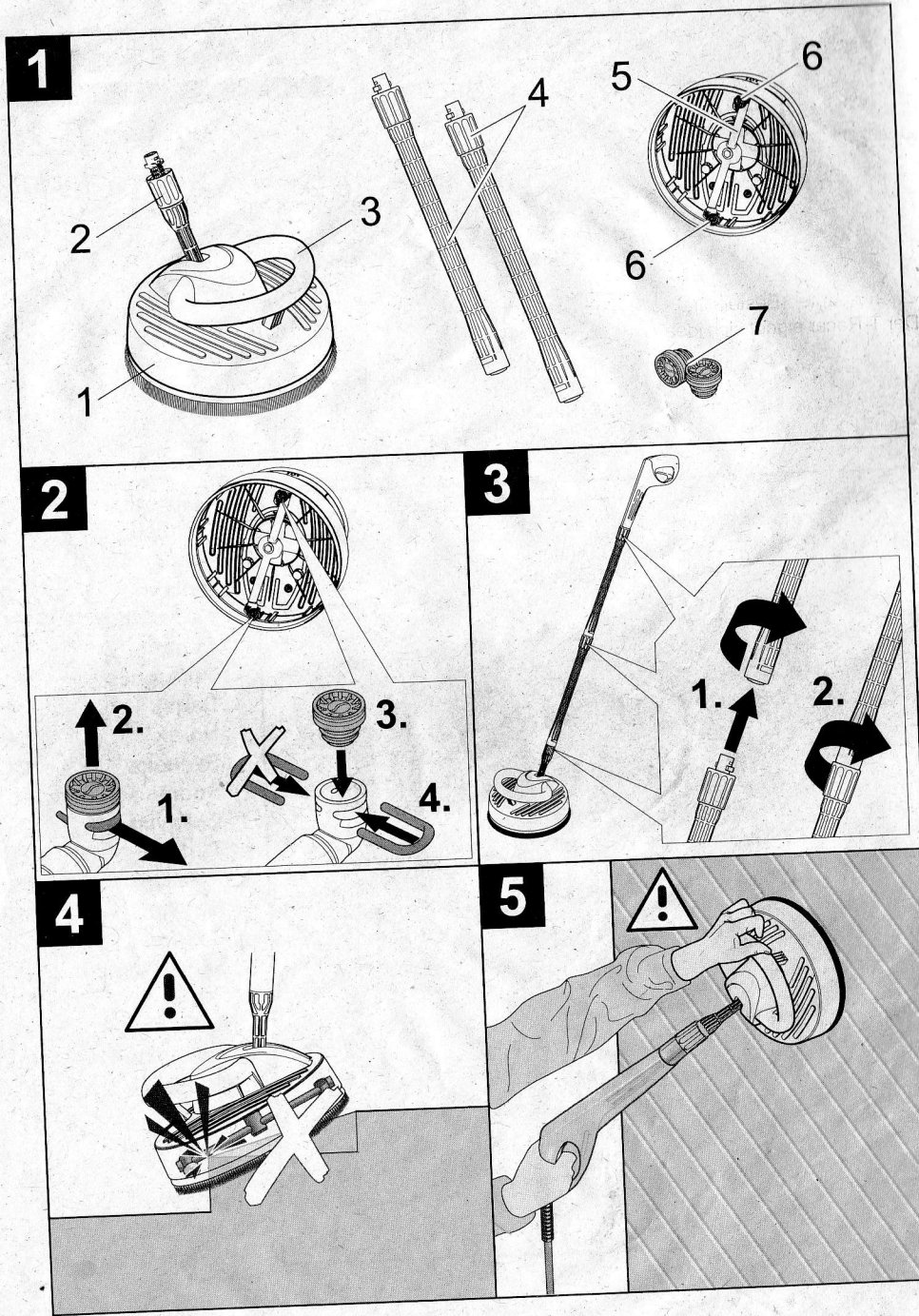

Dear Customer,



Please read and comply with these instructions prior to the initial operation of your appliance. Retain these operating instructions for future reference or for subsequent possessors.

Proper use

The T-Racer can be used with all Kärcher high-pressure cleaners. For units constructed in 1991 and earlier you need an additional adapter (order no.: 4.762-062).

The T-Racer is ideally suited for the cleaning of floor and wall surfaces made of different materials, such as wood, plastic, concrete, tiles, and natural stone. Use the T-Racer exclusively in your private household.

Environmental protection



The packaging material can be recycled. Please do not place the packaging into the ordinary refuse for disposal, but arrange for the proper recycling.



Old appliances contain valuable materials that can be recycled. Please arrange for the proper recycling of old appliances.

Please dispose your old appliances using appropriate collection systems.

Warranty

The terms of the guarantee applicable in each country have been published by our respective national distributors. We will repair possible faults on your unit free of charge within the warranty period, insofar as the faults are caused by material defects or defective workmanship. Guarantee claims should be addressed to your dealer or the nearest authorized customer service centre, and supported by documentary evidence of purchase.

Symbols



Danger!

Do not hold under the edge of the T-Racer when it is on!

Safety instructions

- Please observe the safety instructions of your high-pressure cleaner.
- The T-Racer must not be used by children.
- Only trigger the high-pressure jet at the high-pressure gun if the T-Racer is located on the surface to be cleaned.
- There must be no persons in the immediate vicinity of the cleaning head.
- Beware of the recoil force! Ensure a stable position and firmly hold the high-pressure gun with the extension tube or the handle.
- Switch off the high-pressure cleaner when you finish cleaning. If you are using the T-Racer then disconnect the same from the high-pressure gun.
- Maximum water temperature 60°C (please observe the instructions of your high-pressure cleaner).

Preparing the Appliance

Description of the Appliance

When unpacking the product, make sure that no accessories are missing and that none of the package contents have been damaged. If you detect any transport damages please contact your dealer.

Illustrations on Page 2

- 1 Casing
- 2 Bayonet connection with safety cover
- 3 Handle
- 4 Extension tubes (two tubes)
- 5 Rotating nozzle holder
- 6 Black high-pressure nozzles (2 pieces)
- 7 Grey high-pressure nozzles (2 pieces)

Selecting the high-pressure nozzles

You need to use the matching high-pressure nozzles to ensure that your high-pressure cleaner works properly.

Note: Nominal pressure (p): See Operating Instructions or type plate of your high-pressure cleaner.

High-pressure cleaner with nominal pressure (p) of 13 MPa (130 bar) to 16 MPa (160 bar)
eg: K 6.50 – K 7.91, Kärcher 600 – Kärcher 770

→ Use black high-pressure nozzles.

Note: The black high-pressure nozzles have already been installed.

High-pressure cleaner with nominal voltage (p) lesser than 13 MPa (130 bar)

eg: K 2.00 – K 5.91, Kärcher 201 – Kärcher 560

→ Use grey high-pressure nozzles.

Note: You must replace the black high-pressure nozzles that have been installed with grey ones.

Changing the high-pressure nozzles

→ Illustration 2

- 1 Remove the clip.
- 2 Pull out the black high-pressure nozzle.
- 3 Insert the grey high-pressure nozzle.
- 4 Re-insert the clip.

Application

Note: Always use Kärcher water filter (order no. 4.730-059.0) during suction operations of the high-pressure cleaner.

Cleaning floor surfaces

Fasten the T-Racer to the high-pressure gun using the extension pipes.

→ Illustration 3

- 1 Press the extension tube into the bayonet connection of the high-pressure gun, then turn by 90° until it locks into place.
- 2 Tighten the safety cover.

Repeat this process even for the other joints.

→ Illustration 4

⚠ Caution

Do not run over free-standing corners!

The T-Racer is not suited for scouring or scrubbing!

Outdoor surfaces should be swept before the T-Racer is used to avoid damaging the high-pressure nozzles.

Cleaning wall surfaces

Fasten the T-Racer directly to the high-pressure gun.

- 1 Press the bayonet connection of the T-Racer into the connection of the high-pressure gun, then turn by 90° until it locks into place.
- 2 Tighten the safety cover.

→ Illustration 5

⚠ Caution

Always hold the T-Racer at the handle while cleaning the walls.

Troubleshooting

High-pressure cleaner does not build up the pressure or is vibrating.

→ Dismantle the high-pressure nozzles, check the high-pressure nozzles for damage, rinse the T-Racer with clean water then reinstall the high-pressure nozzles.

General notes

Tip

- You can use the extension pipes with any other Kärcher accessory.

Maintenance and care

Care

Use a moist cloth and clean the appliance after use.

Maintenance

The appliance is maintenance-free.

Spare Parts

Only use original KÄRCHER spare parts. You will find a list of spare parts at the end of this document.